

Institute of Neurological Sciences, Côte d'Ivoire

The ISNA project involves the construction of a 120-bed neurology hospital on government owned land of approximately 17,000 square meters in the outskirts of Abidjan. The mandate involves Study, Construction of buildings, Supply and installation of medical and technical equipment, office furniture, computer equipment and logistics, Staff training, and Project Management. The contract of US\$ 90 million has the approval from Export Development Canada for financing through a Government to Government sole sourcing model initiated through Govt. of Canada.

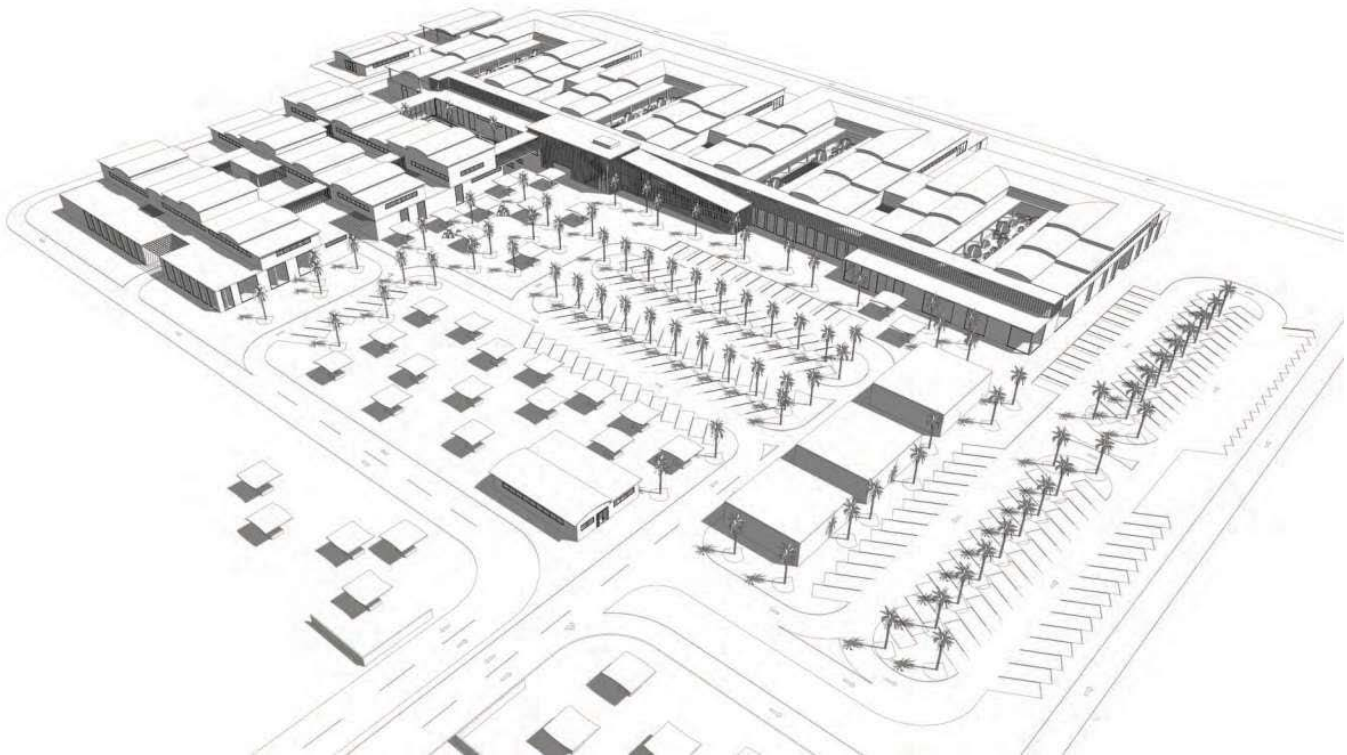

Unit 2050 - 1055 West Georgia Street, Vancouver, BC, V6E 3P3, Canada
Tel: (604) 684 2181 - Fax: (604) 682 4768

www.minaean.com